

4

3

2

1

- 1.0 GENERAL NOTES
 1.1 ALL METRIC DIMENSIONS ARE IN BRACKETS [X.X]
 1.2 FEATURES CRITICAL TO QUALITY ARE INDICATED IN ROUNDED BOX (X.X)
 1.3 3D DIGITAL FILES ARE FOR REFERENCE. IN CASE OF CONFLICT FOLLOW PDF DRAWING.
- 2.0 DESIGN NOTES
 2.1 ALL BENDS SHALL HAVE A BEND RADIUS OF ≥ 1X MATERIAL THICKNESS, UNLESS OTHERWISE SPECIFIED
- 3.0 MANUFACTURING/SPECIAL REQUIREMENTS
 3.1 BREAK SHARP EDGES AND DEBURR PART FOR SAFE HANDLING
 3.2 GALVANIZE PER ASTM A123. COLD SPRAY CUTTING SECTIONS
 3.3 MARK WITH PART NUMBER, REVISION, AND VENDOR ID WITH ETCH, STAMP OR LABEL. CHARACTERS TO BE 0.12" TO 0.24" HIGH AND LEGIBLE TO THE UNAIDED EYE.
- 4.0 TEST
- 5.0 PACKAGING
 5.1 PACKAGING SHALL MEET ANDREW REQUIREMENTS PER DOCUMENT IS-PL-3005

REVISIONS			
REV.	DESCRIPTION	DATE	APPROVED
A	INITIAL RELEASE	AW 02/10/05	
B	UPDATED DRAWING TO NEW FORMAT	RY1002 11SEP25	BA1025 50104902AMO

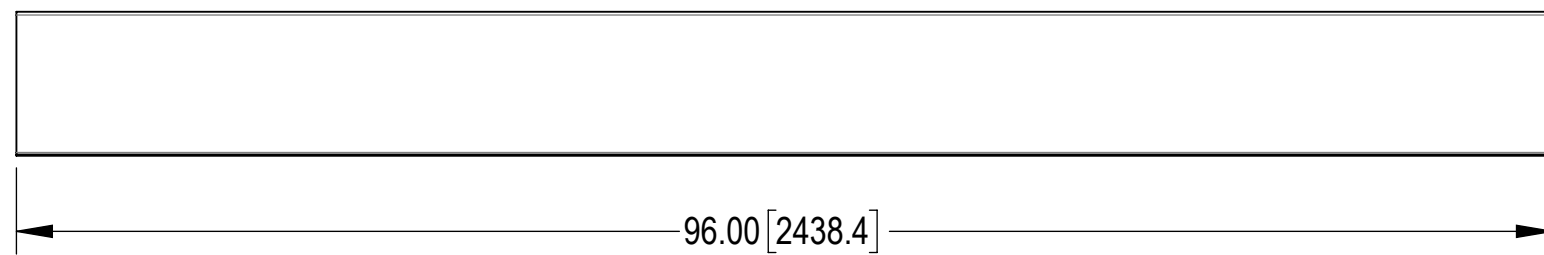
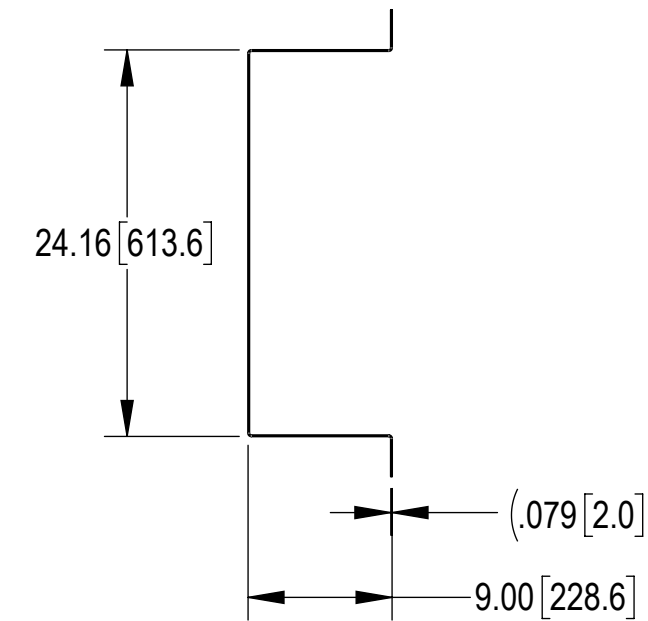
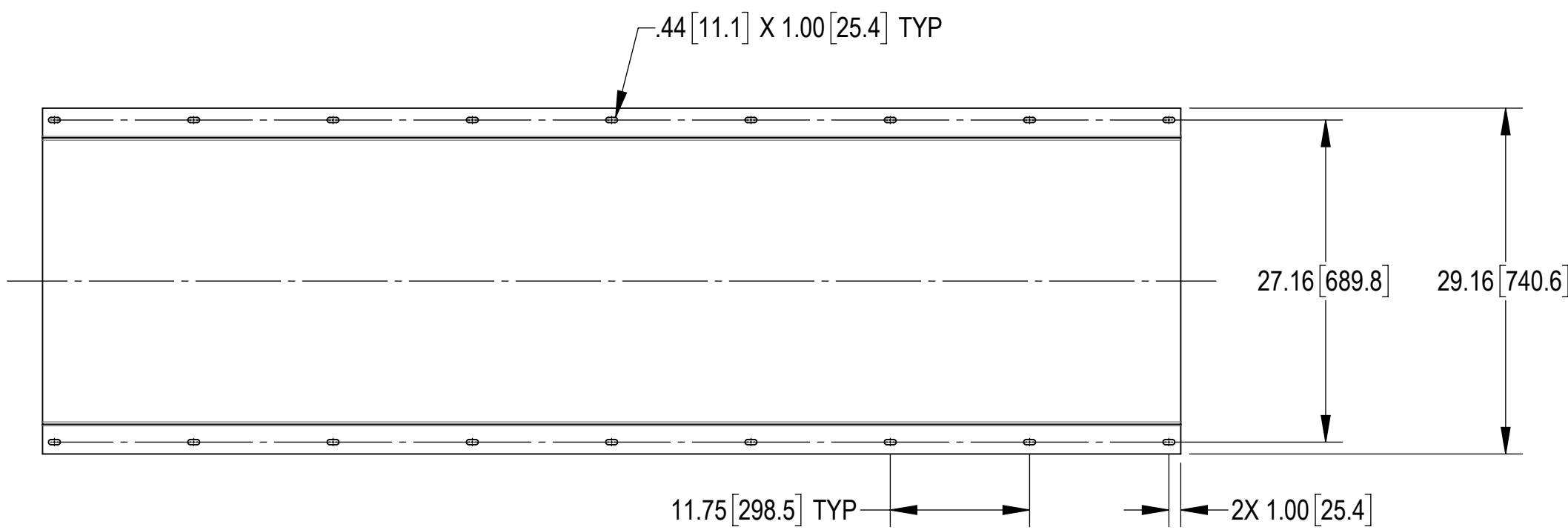
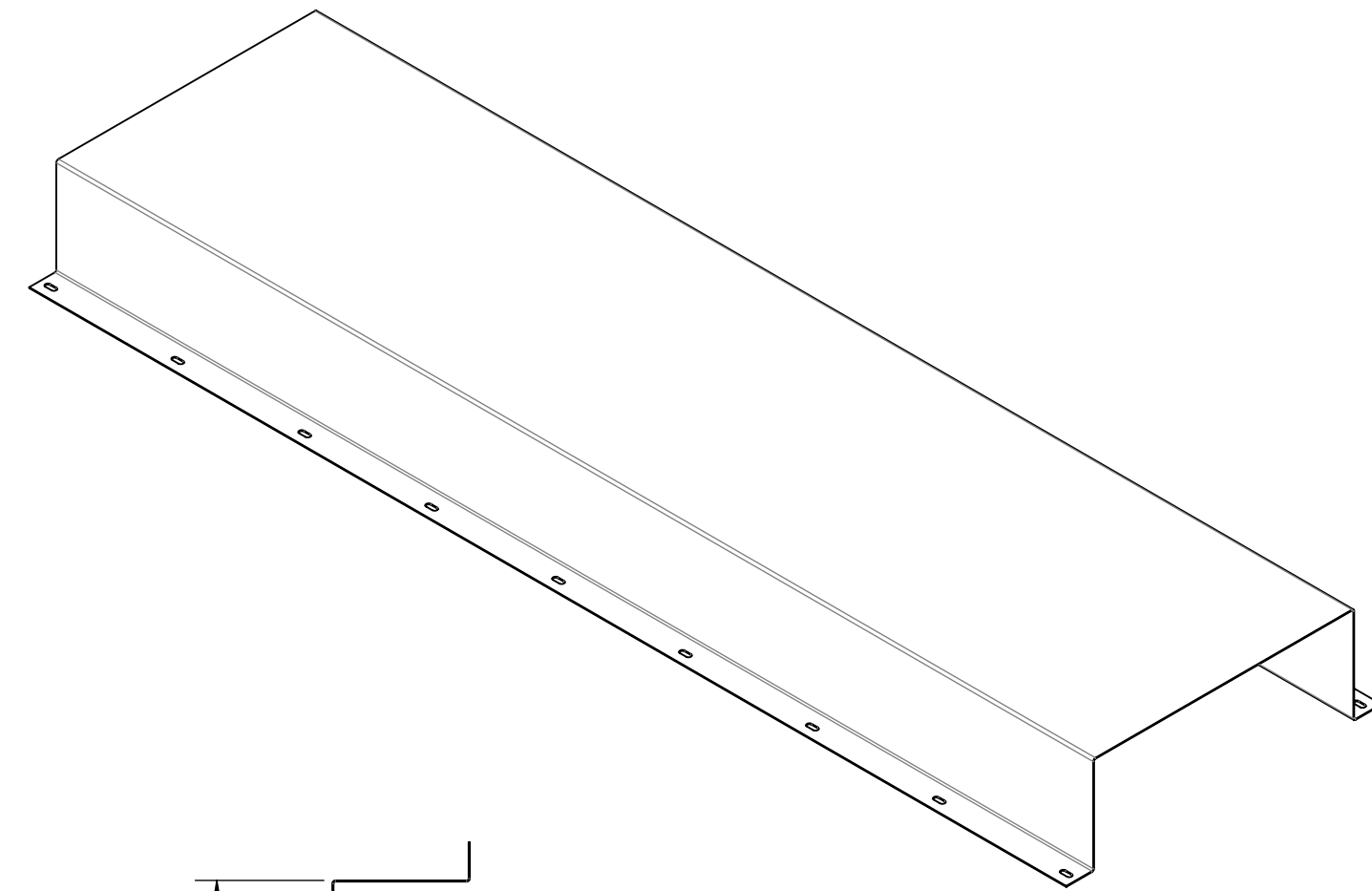

TOLERANCES		SAP MATERIAL MASTER
1 PLACE .X[X] ± 0.06[1.5]	3 PLACE .XXX[X] ± 0.010[0.3]	WC-SC8D
2 PLACE .XX[X] ± 0.03[0.8]	ANGLES ± 2°	

FINISH	3.2	MATERIAL	SHEET, STEEL, 0.079" THICK A568
--------	------------	----------	------------------------------------

UNLESS OTHERWISE SPECIFIED DIMENSIONS ARE IN INCHES INTERPRET PER ANSI Y 14.5M-1994	NAME	DATE	TITLE	
	CE AW	02/10/05	WALL COAX COVER, 8 RUNS, DOUBLESTACK	
	RW RY1002	09/17/2025		
	AD YMENG	09/17/2025	SCALE	DOCUMENT NO.
	RE YMENG	09/18/2025	1:12	WC-SC8D
ECN	50104902AMO			

DENSITY	0.28	lbs/in³
MASS	99.94	lbs
VOLUME	351.51	in³
SURFACE AREA	8981.53	in²
HEIGHT	9.00"	
LENGTH	96.00"	
WIDTH	29.16"	

SIZE	Auth Group	INSL	MODEL	DRAWING			SHEET		
C			VERSION	STATUS	REVISION	VERSION	STATUS	REVISION	1 OF 2
			00	RE	A	01	RE	B	

Confidential

4

3

2

1

4

3

2

1

D

D

C

C

B

B

A

A

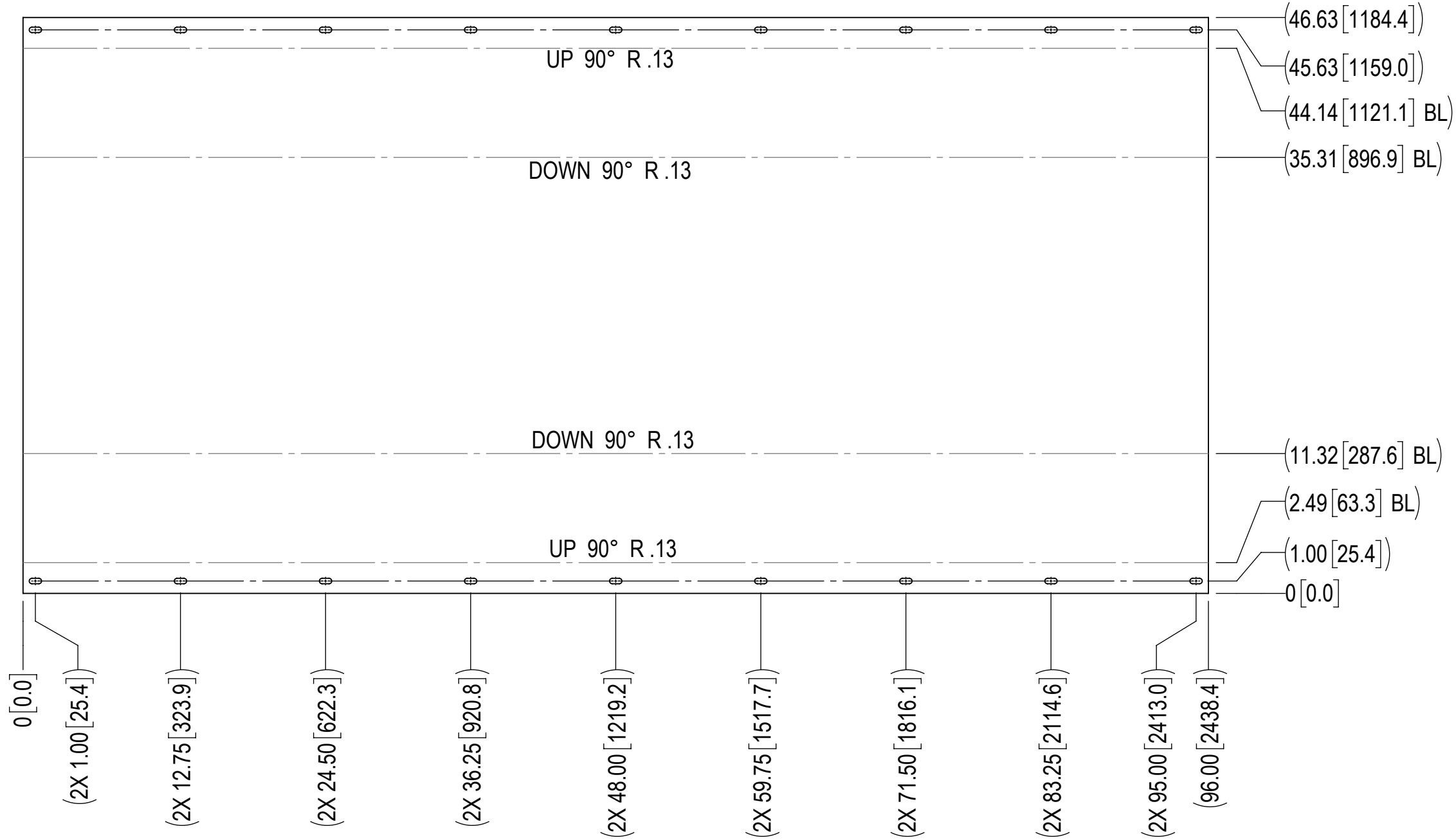

FLAT PATTERN FOR REFERENCE ONLY



TITLE
WALL COAX COVER, 8 RUNS, DOUBLESTACK

SIZE C	SCALE 1:10	DOCUMENT NO. WC-SC8D
------------------	----------------------	-------------------------

	DRAWING			SHEET 2 OF 2
	VERSION 01	STATUS RE	REVISION B	

Confidential

4

3

2

1

