

- 1.0 GENERAL NOTES
 1.1 ALL METRIC DIMENSIONS ARE IN BRACKETS [X. X]
 1.2 FOR PATENT INFO: <https://www.adwpat.com>
 2.0 DESIGN NOTES
 3.0 MANUFACTURING/SPECIAL REQUIREMENTS
 3.1 TIGHTEN ALL BOLTS SECURING FLAT PLATES BY THE TURN-OF-NUT METHOD. TIGHTEN ALL U-BOLTS USING TURN-OF-NUT METHOD WITH ATTENTION TO LEAVE EQUAL DISTANCE AND EQUAL FORCE ON EACH LEG OF THE U-BOLT.
 3.2 INCLUDED SLEEVES (ITEMS 10 & 11) & NUT (ITEM 9) TO BE INSERTED IF REQUIRED FOR TOWER TAPER.
 3.3 OFFSET SLEEVES MAY BE CUT FOR DIFFERENT TAPER.
 4.0 TEST
 5.0 PACKAGING
 5.1 PACKAGING SHALL MEET ANDREW REQUIREMENTS PER DOCUMENT IS-PL-3005
 5.2 PRINTED DOCUMENT TO BE PLACED INSIDE POLYBAG AND THEN IN SHIPPING CONTAINER
 5.3 EXTRA HARDWARE MAY BE SUPPLIED, BAGGED AND SHIPPED

REVISIONS			
REV.	DESCRIPTION	DATE	APPROVED
A	INITIAL RELEASE	JTS 04/06/01	
B	UPDATED DRAWING TO NEW FORMAT	RY1002 13OCT25	BA1025 50105335AMO

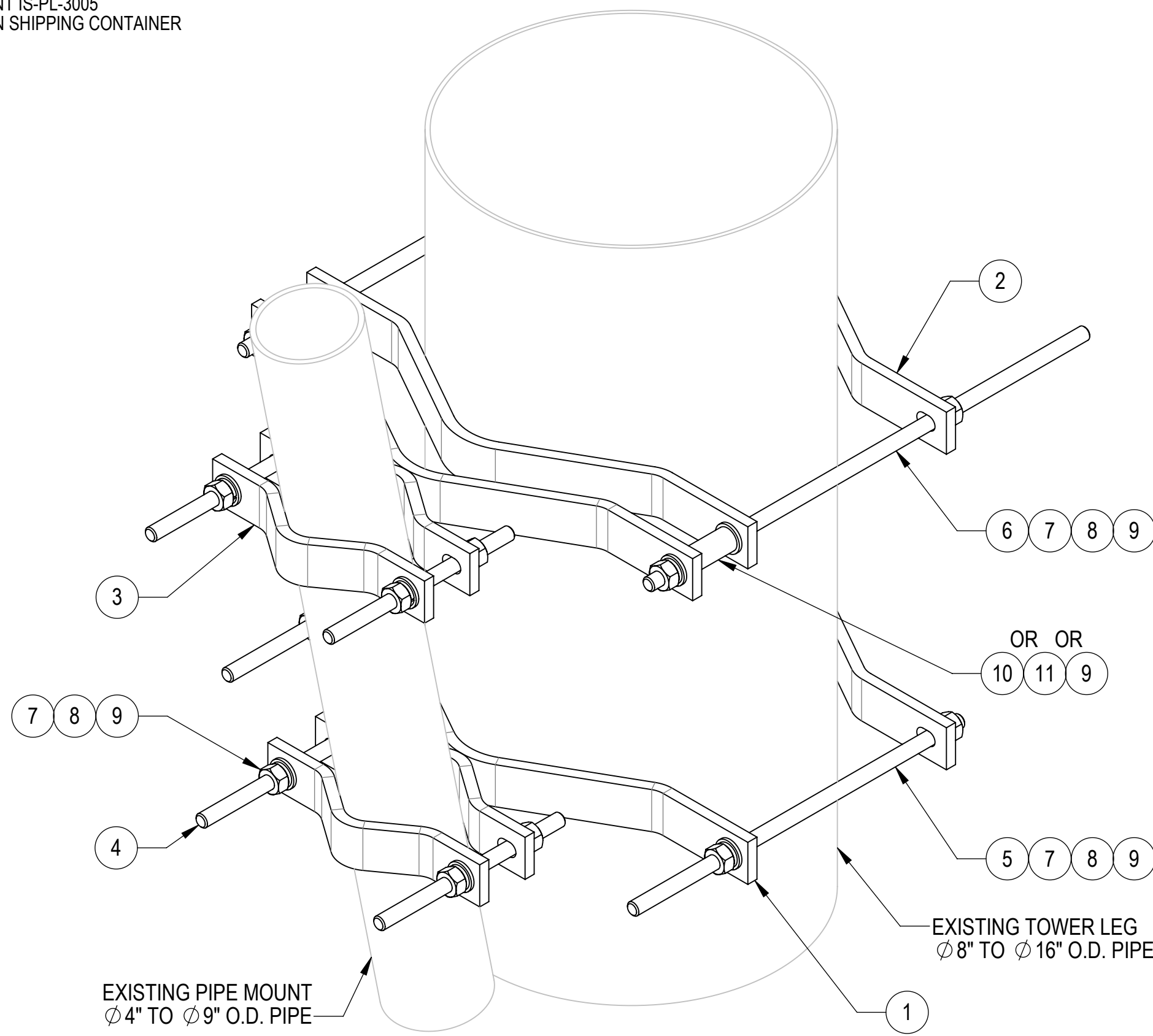

**COMPONENT PART NUMBERS PROVIDED FOR ASSEMBLY PURPOSES;
 INDIVIDUAL COMPONENTS MAY BE SHIPPED AS PARTS WITHIN AN INCLUDED KIT.**

ITEM	PART NO.	DESCRIPTION	QTY.	WEIGHT	NOTE NO.
1	LMA	MEDIUM TO LARGE PIPE ADAPTER	2	10.53 LBS	
2	LCP10	LARGE CLAMP HALF	3	7.17 LBS	
3	MCP10	CLAMP HALF 1/2" 5/8" H/W 2.5-9 PIPE	2	3.40 LBS	
4	MT-381-10	5/8" X 10" GALV THREADED ROD	4	0.86 LBS	
5	MT-382-18	5/8" X 18" GALV THREADED ROD	2	1.55 LBS	
6	MT-382-24	5/8" X 24" GALV THREADED ROD	2	2.07 LBS	
7	GWFO5A	GALV FLAT WASHER HARDENED 5/8", 1.3OD	20	0.04 LBS	
8	GWL-05	5/8" GALV LOCK WASHER	20	0.03 LBS	
9	GN-05A	5/8" GALV HEX NUT (A194 2H)	20	0.12 LBS	
10	OS234	3/4" X 2-1/4" OFFSET SLEEVE	2	0.22 LBS	
11	OS334	3/4" X 3-1/4" OFFSET SLEEVE	2	0.31 LBS	

DENSITY	64.76	lbs/in ³
MASS	229.70	lbs
VOLUME	1422.47	in ³
SURFACE AREA		in ²
HEIGHT	35"	
LENGTH	24"	
WIDTH		

Confidential

TOLERANCES		SAP MATERIAL MASTER	
1 PLACE .X[X] ± 0.06[1.5]	3 PLACE .XXX[X] ± 0.010[0.3]	LM-100-SSH	
2 PLACE .XX[X] ± 0.03[0.8]	ANGLES ± 2°		
FINISH		MATERIAL	
UNLESS OTHERWISE SPECIFIED DIMENSIONS ARE IN INCHES INTERPRET PER ANSI Y 14.5M-1994		NAME	DATE
		CE ACG	02/20/06
		RW RY1002	10/14/2025
		AD YMENG	10/16/2025
RE YMENG	10/16/2025	ADPTR, 4"-9" TO 8"-16" OD, TPD, PIPE-PIPE	
ECN 50105335AMO	SCALE 1:4	DOCUMENT NO. LM-100-SSH	
SIZE	Auth Group	INSL	MODEL
C		VERSION	STATUS
		01	RE
DRAWING		VERSION	STATUS
		01	RE
		REVISION	REVISION
		B	B
		SHEET	1 OF 1